

# PRO POWER

STRENGTH TRAINING EQUIPMENT

## PP310 DUMBBELL FLAT BENCH

### PP310 SPECS

<b>Height</b>	18"
---------------	-----

<b>Width</b>	24"
--------------	-----

<b>Depth</b>	46"
--------------	-----

<b>Foot Print</b>	18" x 24" x 46"
-------------------	-----------------

<b>Weight</b>	60 lbs.
---------------	---------

<b>Material</b>	11 and 7 Gauge Steel
-----------------	----------------------

<b>Paint</b>	Powder Coated
--------------	---------------

<b>Made In</b>	USA
----------------	-----

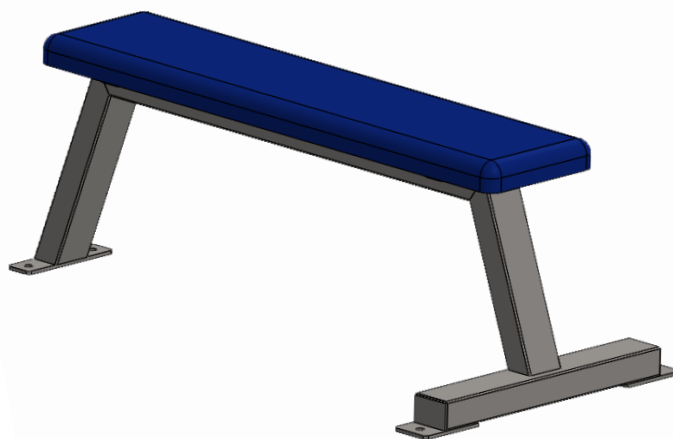

PP310 Dumbbell Flat bench is our most economical bench. Available in custom colors and upholstery. Optional ware cover available.

### FEATURES

Embroidered Logo Cover



Double Stitched and Stapled



Fully Customizable



www.proindustries.com